

ER0034
x 500

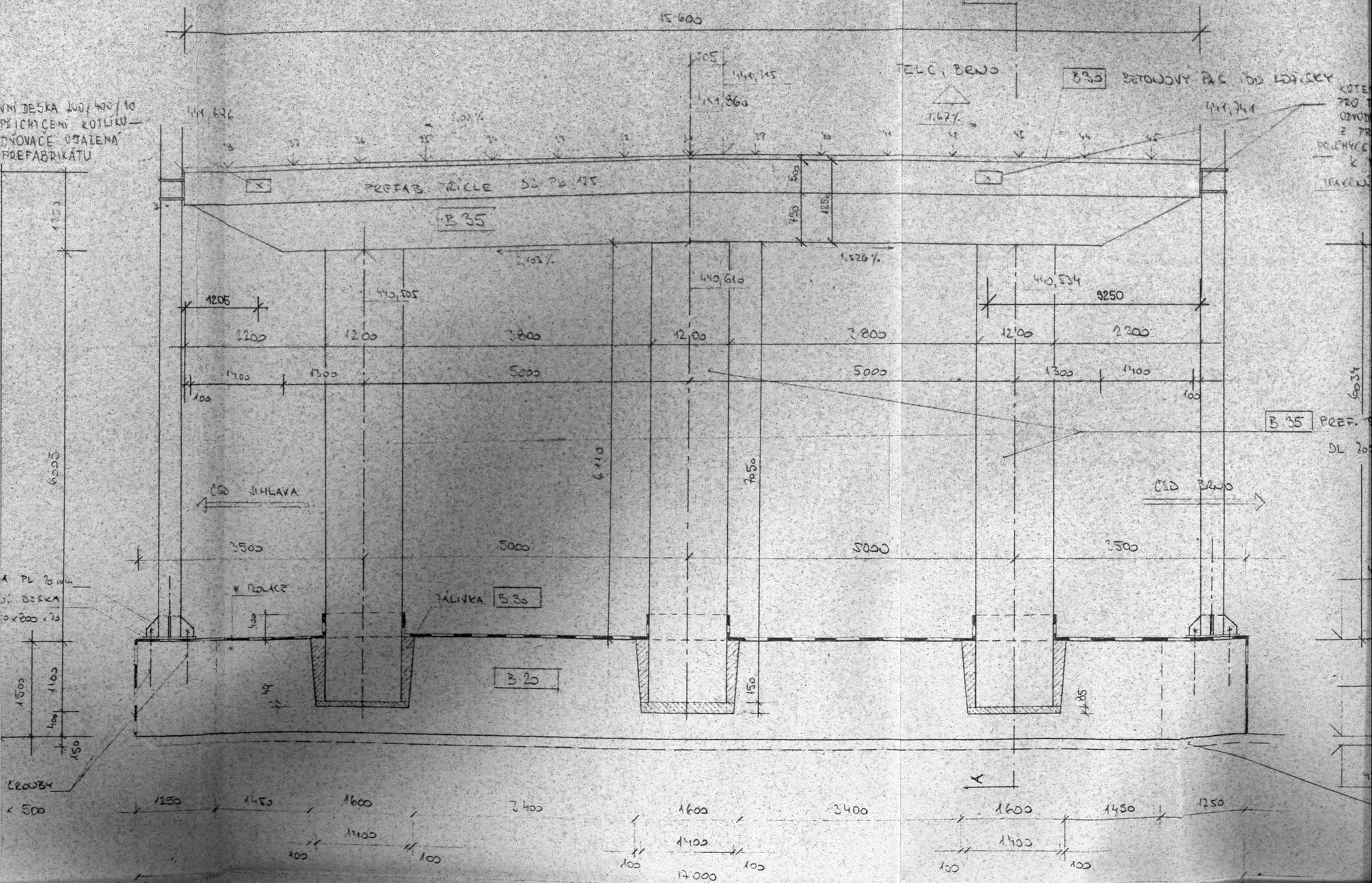

15 600 (1.052)

2800 (1.052)

1800 (1.052)

PROVIDE



8 30

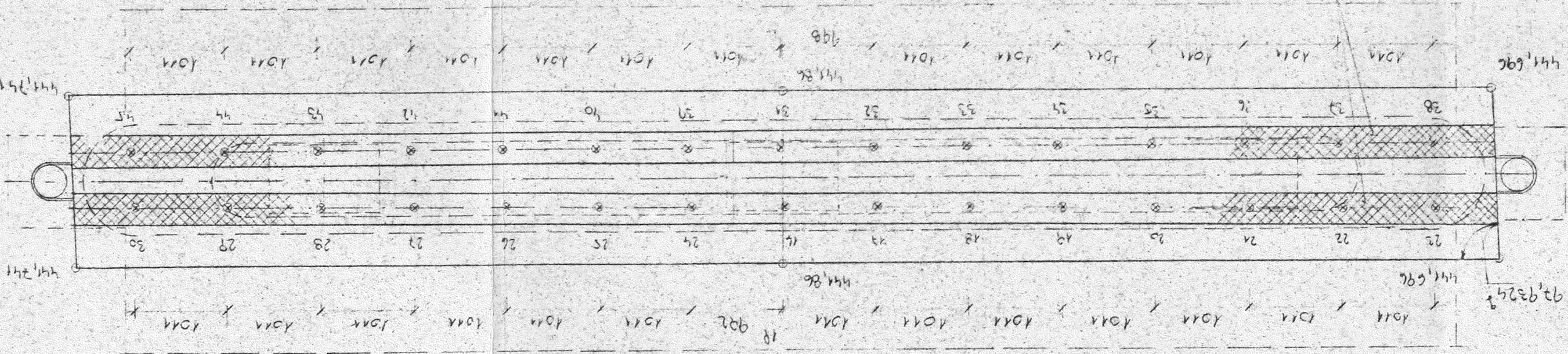

630 x 710 x 630
405 x 350 x 350 x 405

$\alpha = 92.9324^\circ$

BRAND, TELC

PURPOSE

* ISOLATE: 10 ALP + 2x DC 4051

ŘEZ A-A

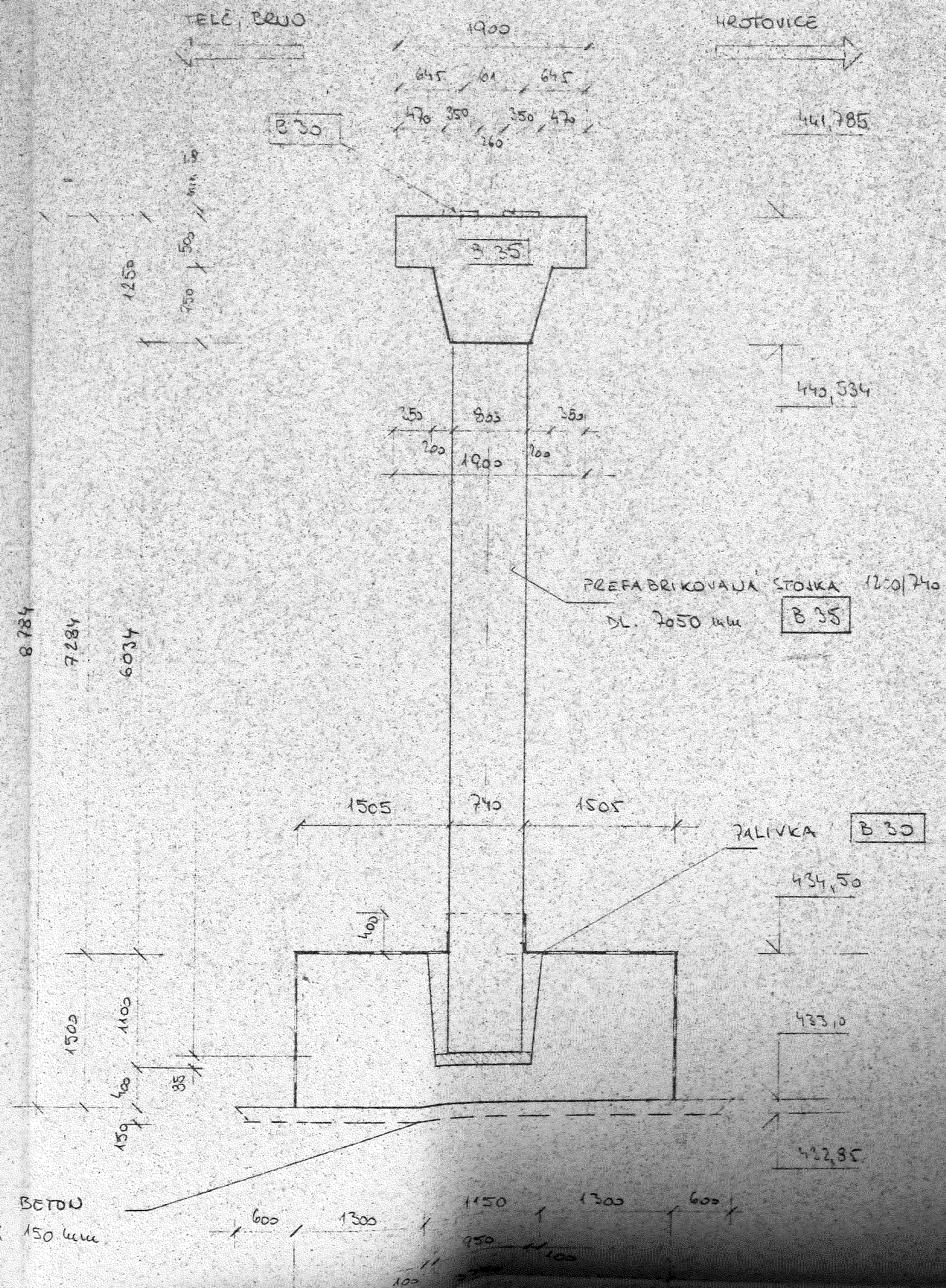
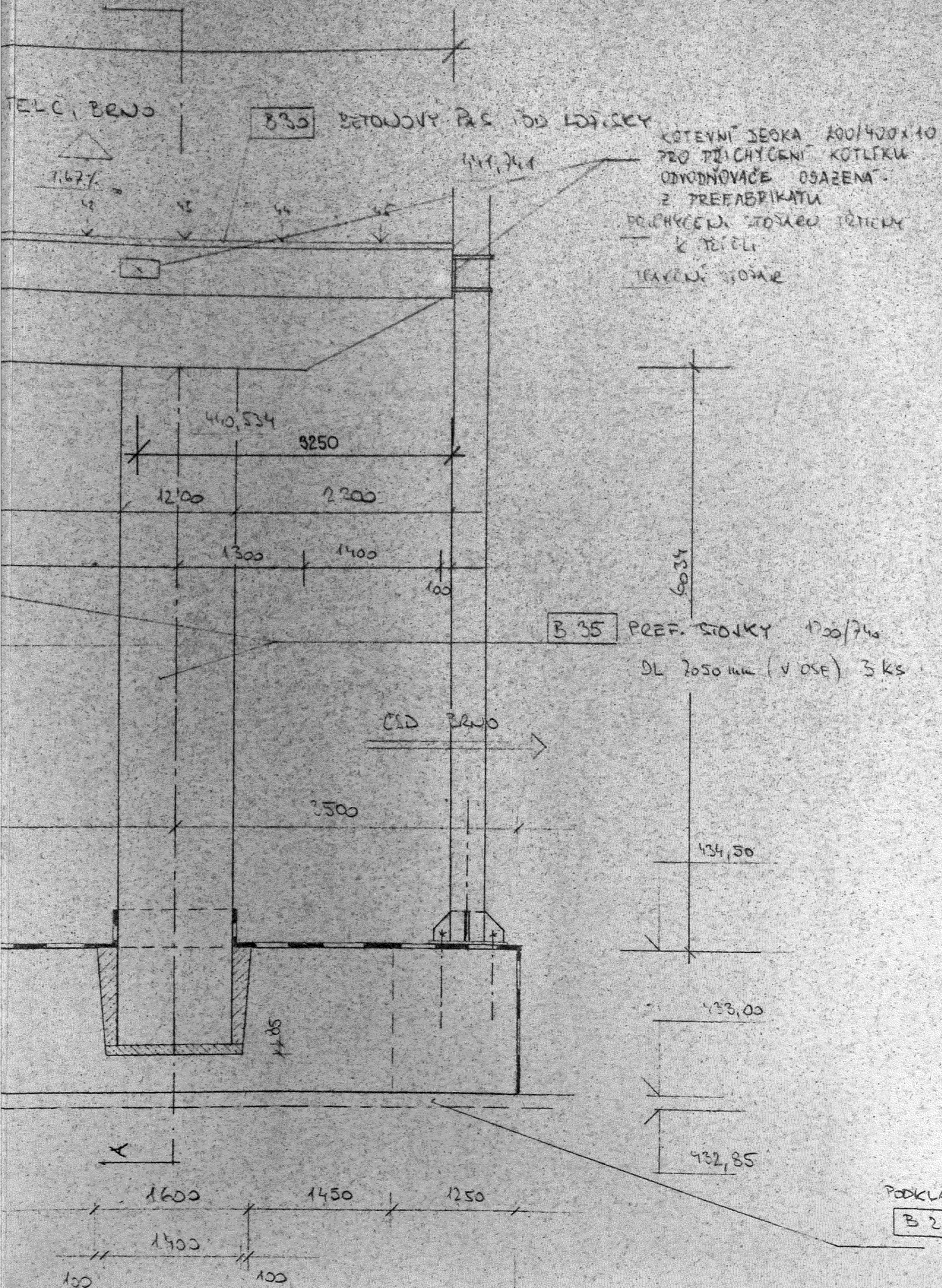

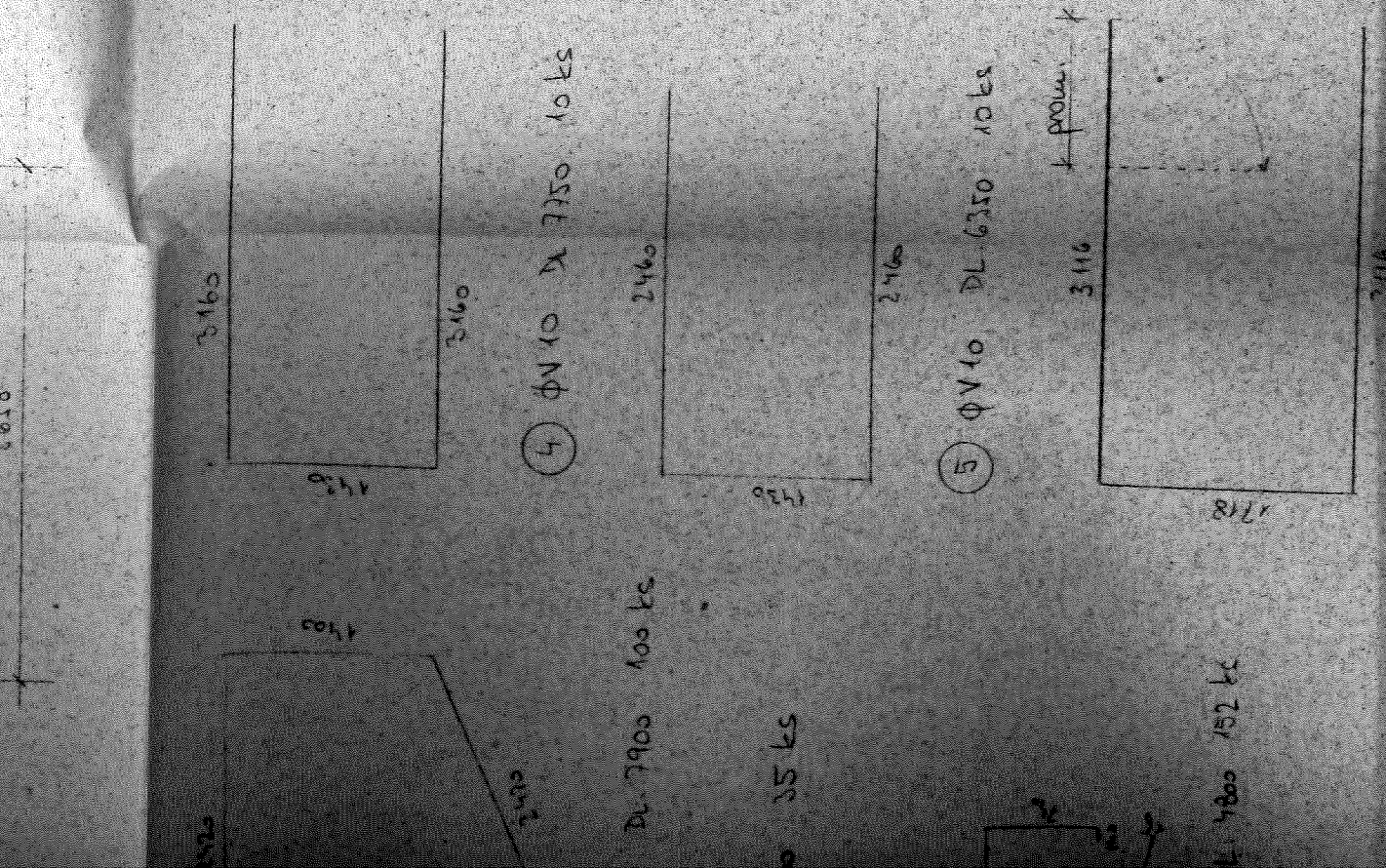

DETAIL D 120

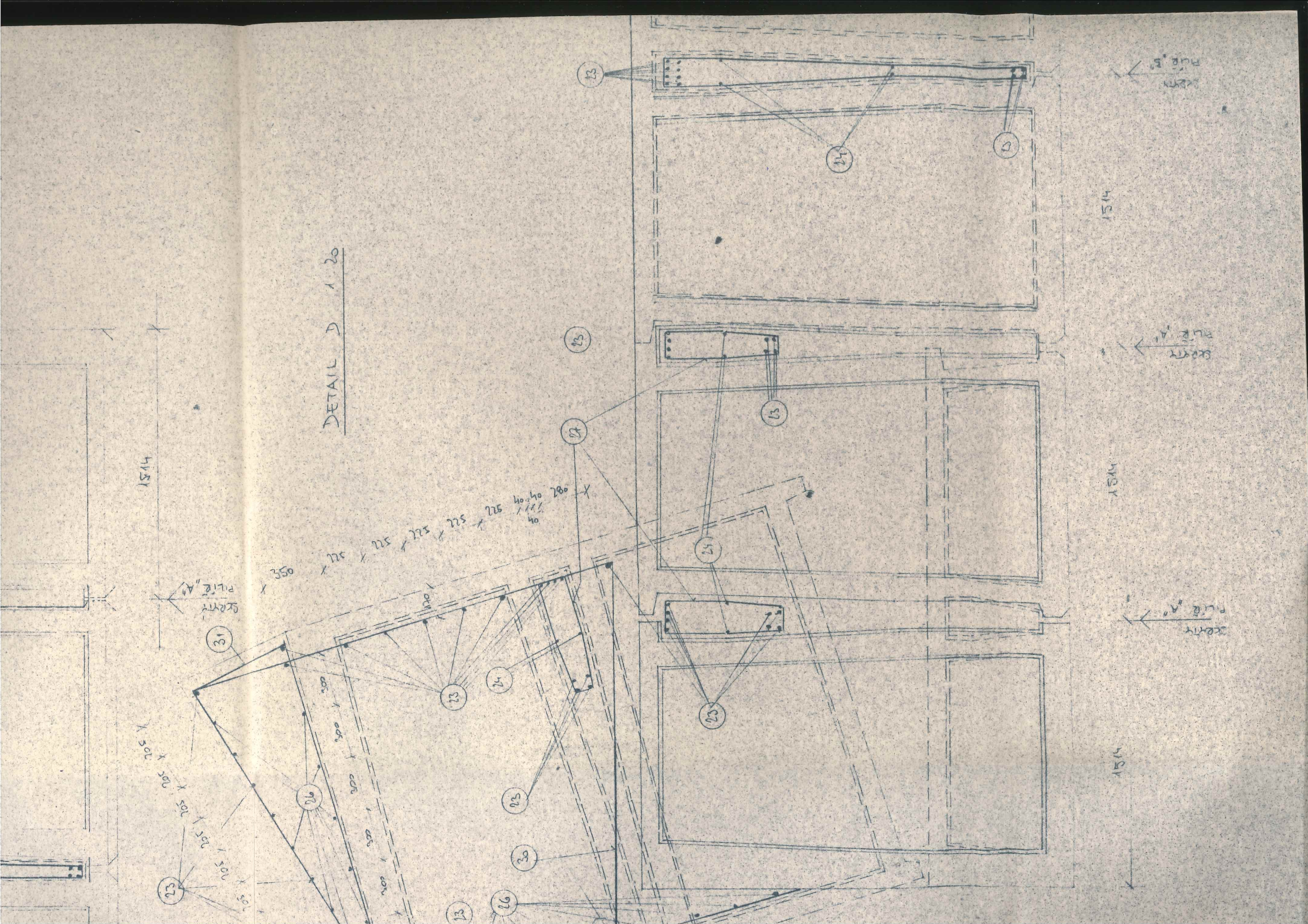

ES VÝZTUŽE ZÁKLADOVÉHO PÁSU PILÍŘE 2

NÝ ŘEZ 1:50

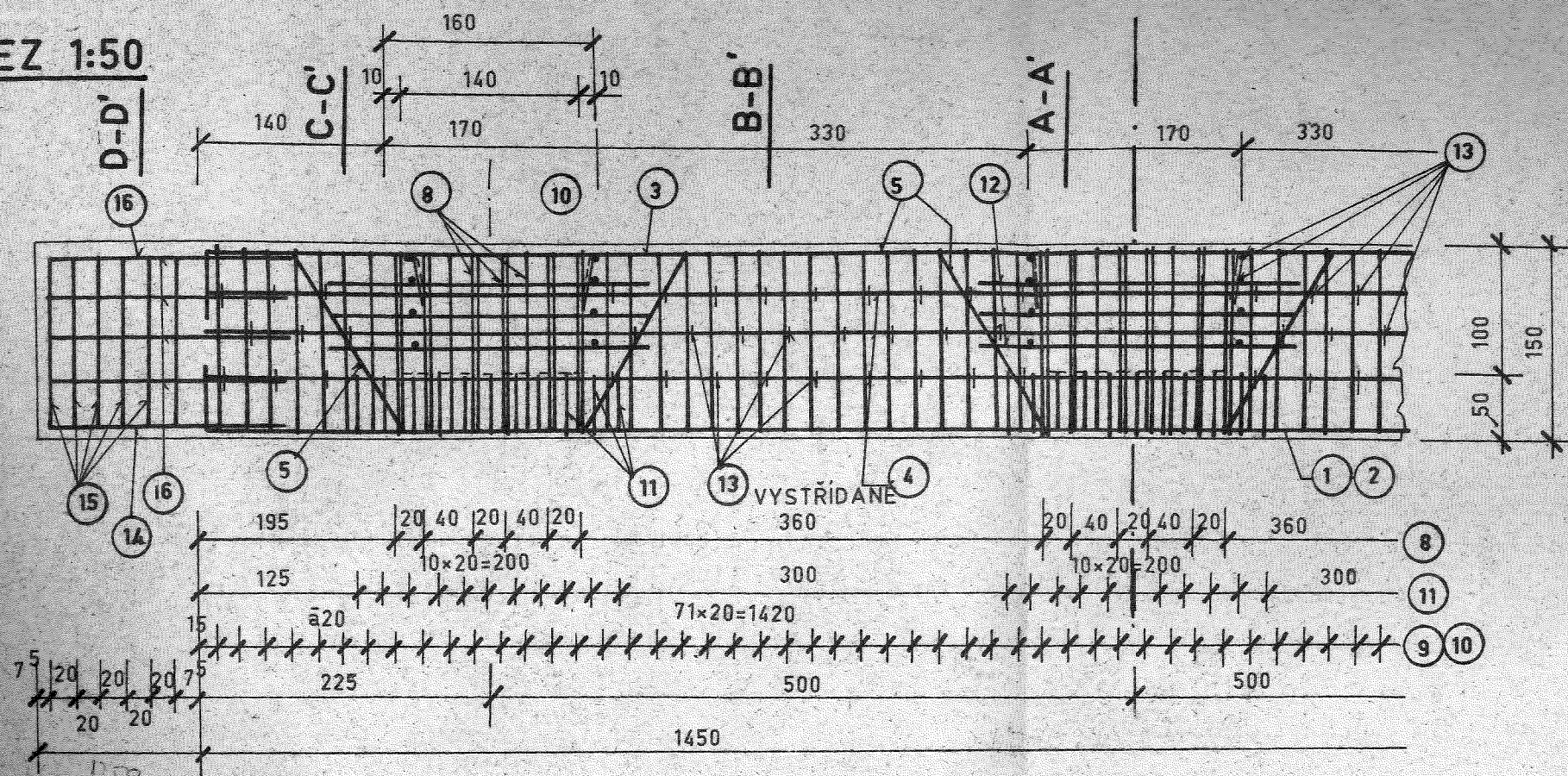

ŘEZ A-A' 1:50

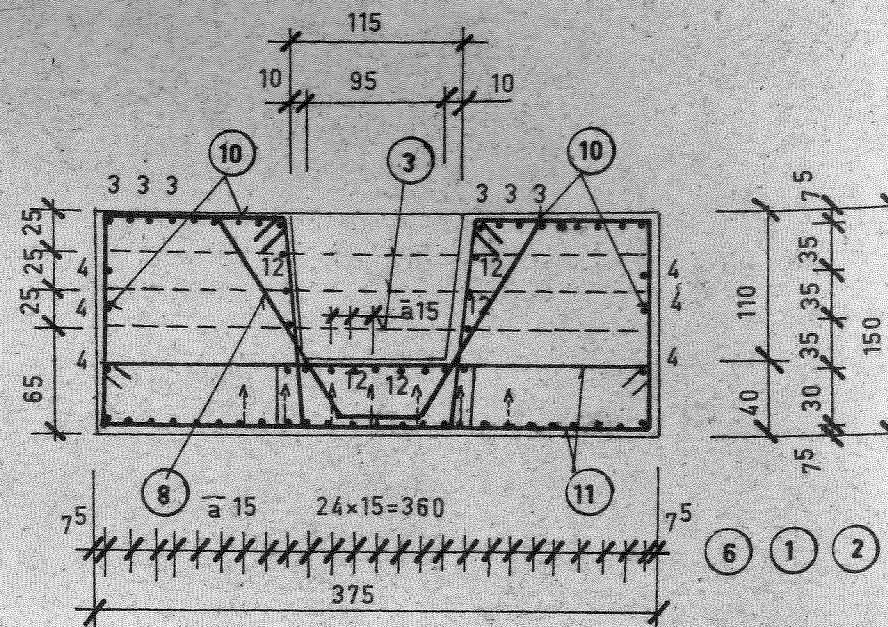

ŘEZ B-B'

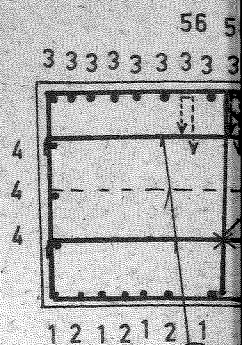

POZNÁMKA: VÝZTUŽ VODIVĚ PROPOJIT SVAŘENÍM
MĚŘICÍ VÝVOD FeZn Ø8mm DL.30cm ks-1

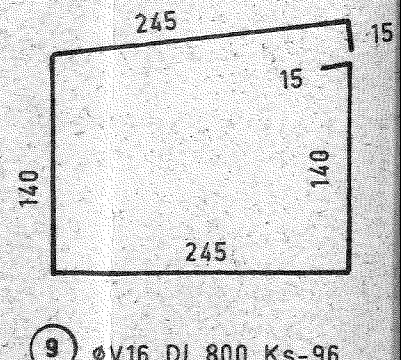
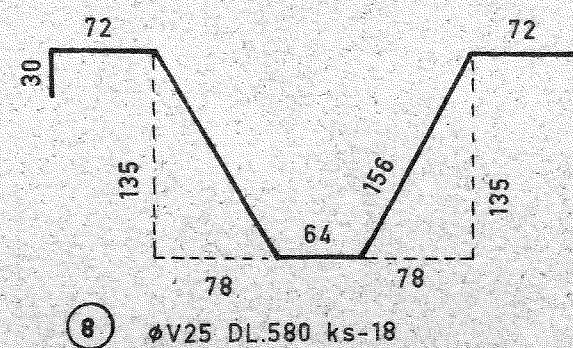
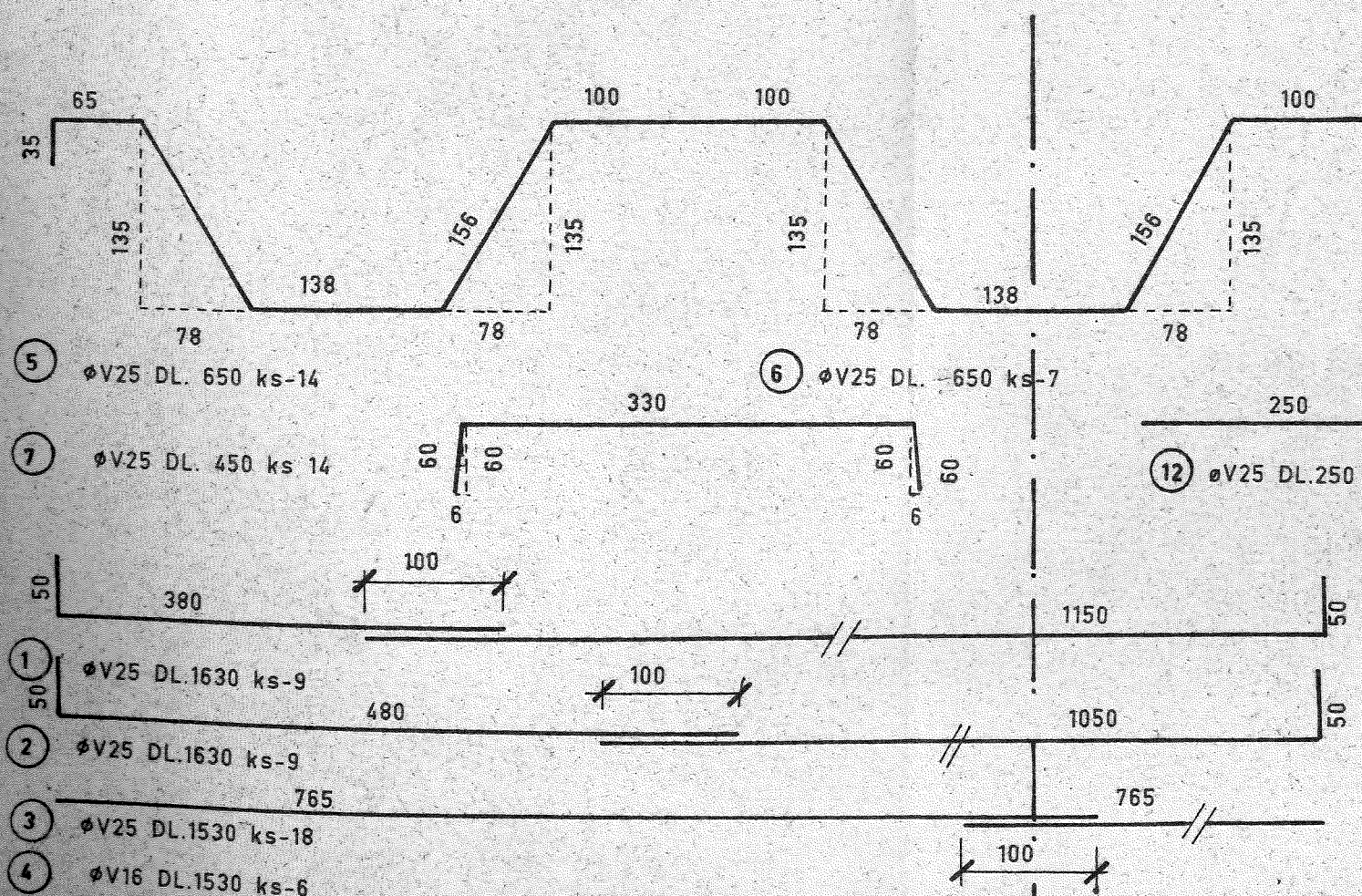

10 ØV16 DL.565 ks-48

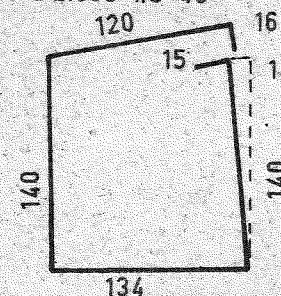

11 ØV16 DL.600 ks-66

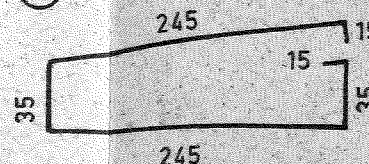

13 ØV14 DL.9390 ks-98

SPOJE VYSTRÍDAT V PŘÍČNÉM
I PODÉLNÉM SMĚRU